

Information: the outdoor areas usable for events are located in the parking area. Their use reduces the amount of parking spaces.

- 42 Spaces
- 3 Spaces

- Property line
- Non-coverable edges/surfaces

**Hurricane Factory Berlin GmbH**  
 Wassmannsdorfer Allee 3  
 12529 Schönefeld

**Direct contact for events:**  
 Julia Waldmann  
 M +49 171 272 44 10  
 E j.waldmann@hurricanefactory.com

**Contact Information/Reception:**  
 T +49 3379 321 73 80  
 info@hurricanefactory.com  
 www.hurricanefactory.com/berlin  
 facebook HurricaneFactoryBerlin

**SITE PLAN: 2. FLOOR**  
**MAIN FLOOR/AUDIENCE AREA**

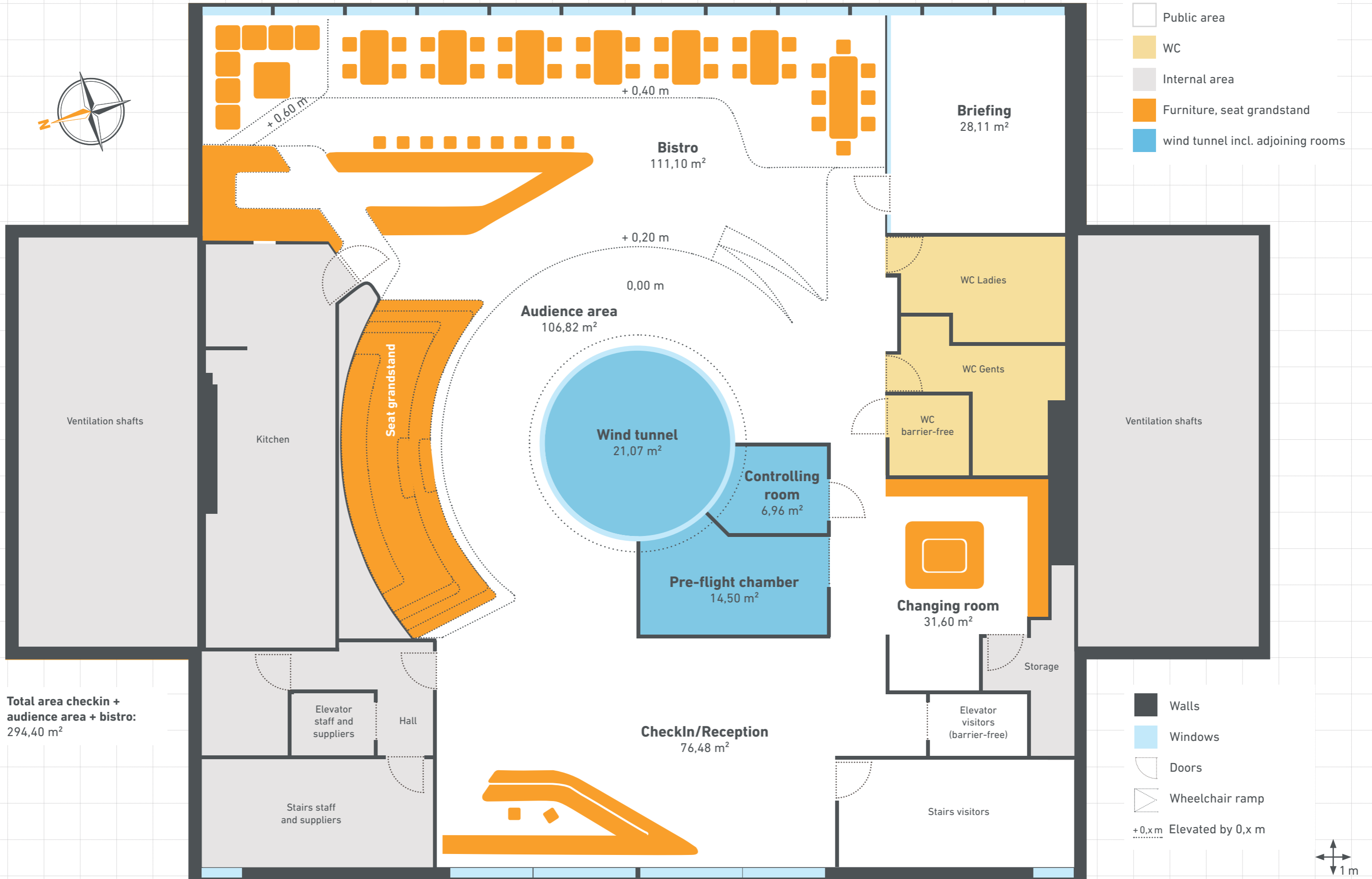

# SITE PLAN: 3. FLOOR

## EVENT AREA

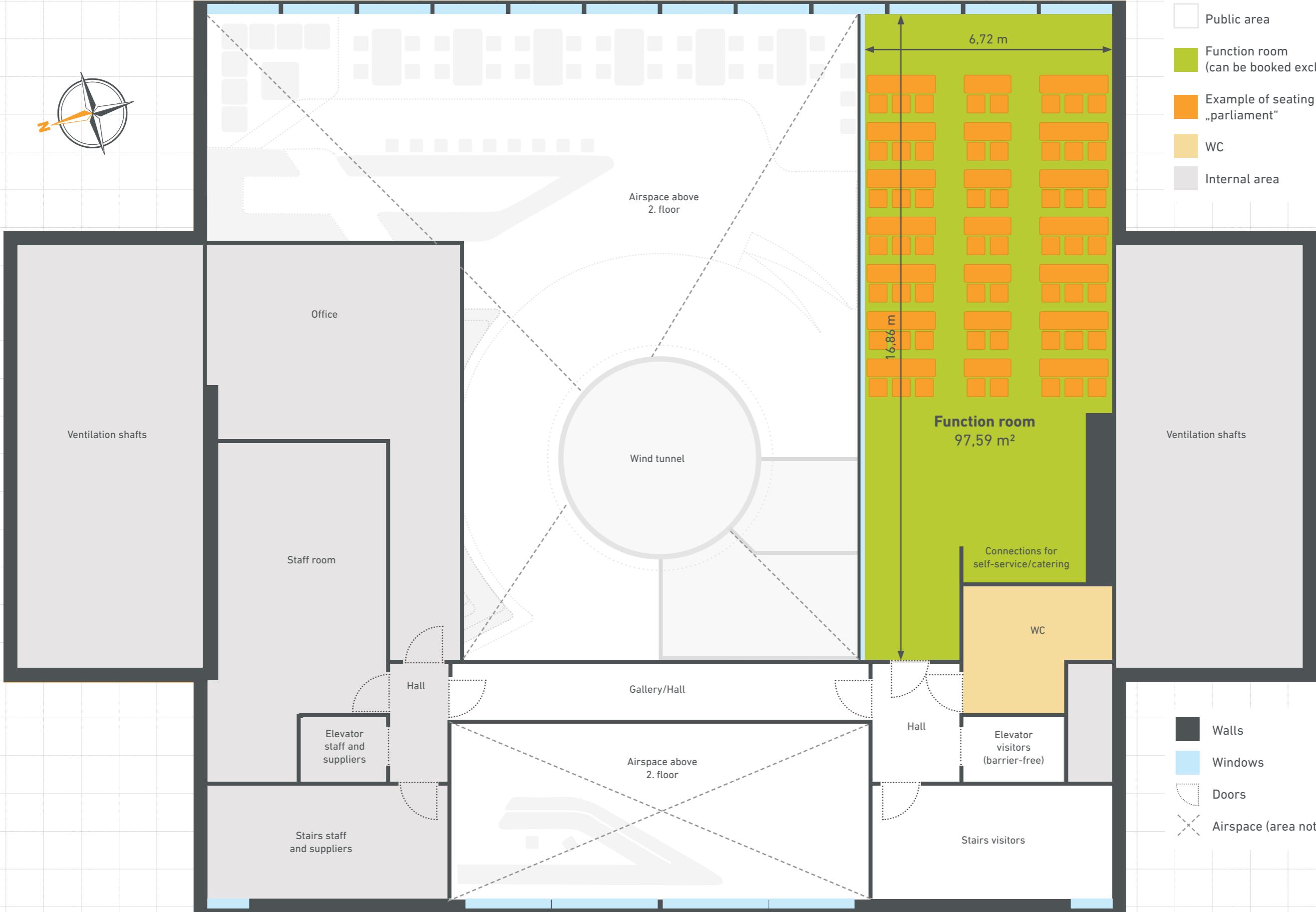
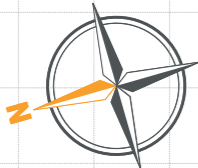

- Public area
- Function room (can be booked exclusively)
- Example of seating „parliament“
- WC
- Internal area

- Walls
- Windows
- Doors
- Airspace (area not accessible)



**SITE PLAN: 4. FLOOR**  
**SPORTS AREA**

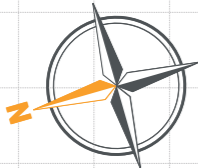

- Sports area
- Sports area (limitedly bookable)
- Terrace (exclusively bookable)
- WC
- Internal area



- Walls
- Windows
- Doors

